

109080300001

4. 零件应符合RoHS2.0标准要求。

COOKOLOGY

SPIN DRYER

Capacity: 4kg

CSPD4WH
CSPD4BK

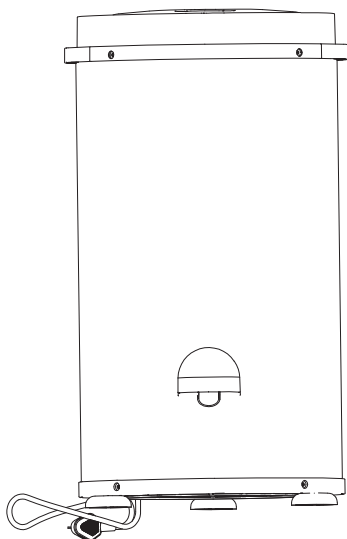

-
- Read the instruction manual carefully before use.
 - The product is based on the actual product.
 - Keep the instruction manual properly for future reference.
 - Please register the warranty for this product on www.Cookology.com
-

**Please remember to register your appliance
for warranty at www.cookology.com**

CONTENTS	Page
Illustrations	4
Description of Parts	5
Points of Safety	6-7
Electrical Information	8
Operating Instructions	9
Technical data	0

Illustrations

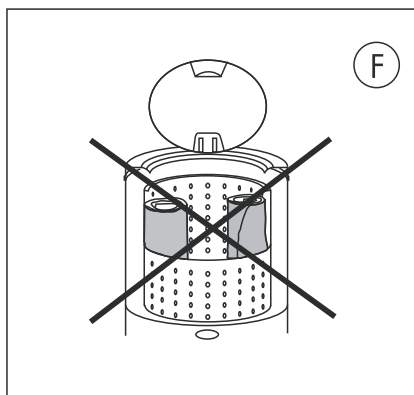
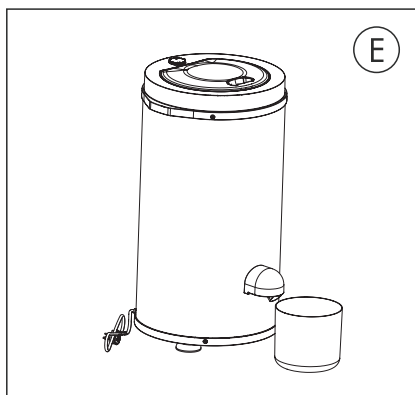
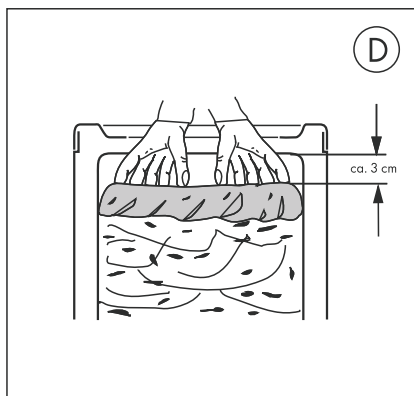
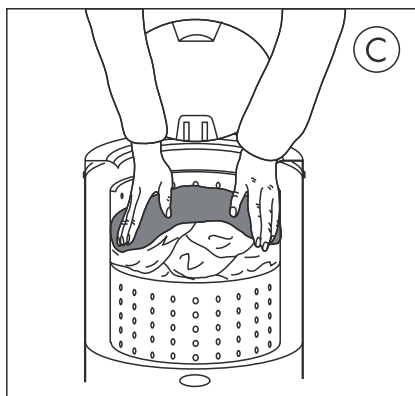
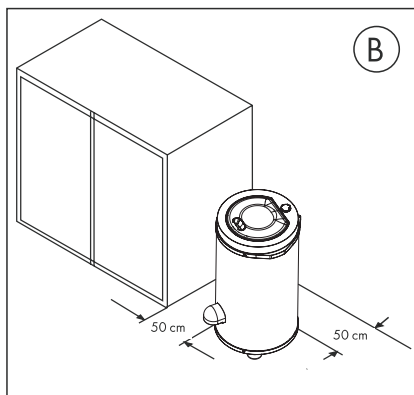
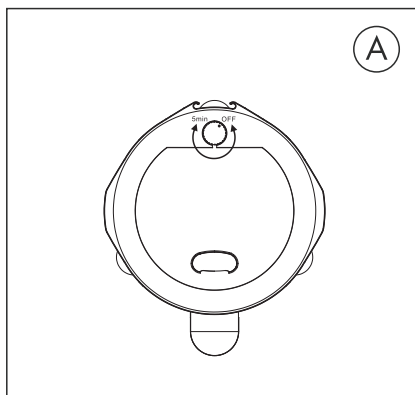

Description of Parts

- | | | |
|---------------------------|----------------------|------------------|
| 1 = Stainless steel drum | 4 = Inner door | 7 = Foot pad |
| 2 = Timer | 5 = Spin press plate | 8 = Water outlet |
| 3 = Top lid | 6 = Outer drum | 9 = Power cord |
| 10 = Water collection pot | | |

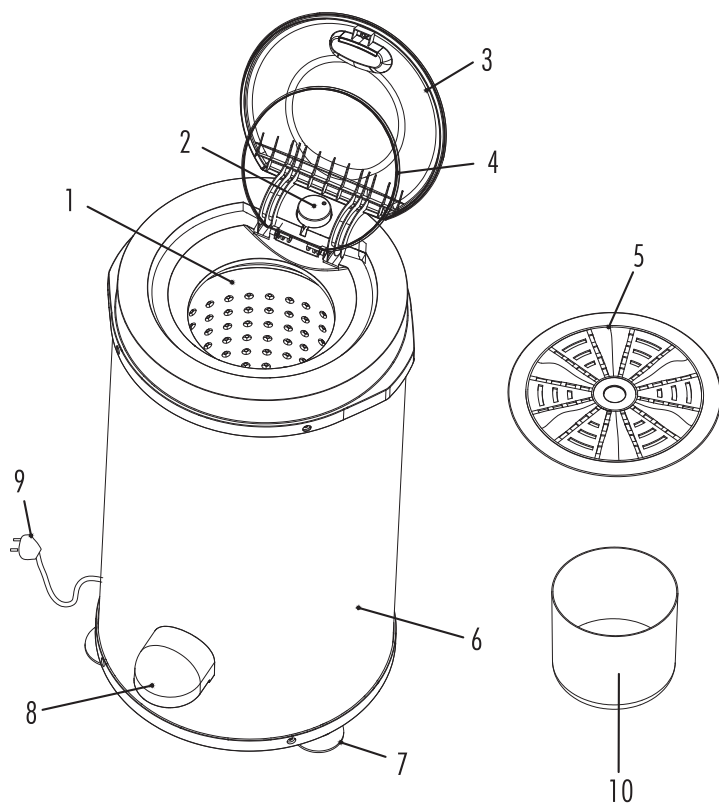

Please read through the information contained in this instructions booklet carefully. It gives important advice on the safety, assembly, use and maintenance of the Spin Dryer. Retain the instructions booklet in a safe place for future reference and, if applicable, pass it on to the subsequent owner of the appliance. The manufacturer will not be liable if the instructions specified below are not observed. Do not put the Spin Dryer to improper use, i.e. do not use the appliance other than for the purposes it is meant for. It is intended for household use and for spinning items of laundry only.

- This appliance can be used by children from 8 years of age, as well as by persons with impaired physical, sensory or mental capacities, or lack of experience and/or knowledge, as long as they are supervised or have been instructed on using the appliance safely, and are aware of the dangers involved. Do not allow children play with the appliance. Cleaning and user maintenance should not be performed by children without supervision.
- Before connecting the appliance, check that the details given on the rating plate correspond to the requirements of your electrical installation.
- Do not operate the appliance if:
 - the mains cable is damaged;
 - the appliance shows clear signs of damage.
- Check the appliance for any damages which may have occurred during transport.
- Dispose of the packing in accordance with local regulations.
- Remove the transport locking pads from inside the drum.
- The spin dryer is intended for use by adults only.
- Ensure that children do not play around with the appliance.
- Modifications to the appliance can endanger your safety and health. Therefore, repairs to the appliance should be carried out by an authorised engineer only.
- Never operate the appliance in rooms where inflammable materials are stored or where gases have formed.
- Never unplug the appliance by pulling on the cable, but only by removing the plug directly from the socket.
- Ensure that the mains cable is not exposed to either heat or chemical substances, nor that it is pulled across sharp edges or surfaces.
- If the mains cable becomes damaged, have it replaced immediately by an authorised repair-shop.
- Do not touch or use the appliance with wet hands or when barefoot and standing on a wet floor.
- Do not expose the appliance to atmospheric effects, such as sun, rain, etc.
- **NEVER** add water to the drum, e.g. for „rinsing“

The basic safety regulations must be strictly observed. In case of doubt, have a qualified engineer inspect the electrical installation of your house. Electrical security is only ensured when the appliance has been duly earthed, as described under the safety regulations for electrical connections.

If the mains socket does not comply with the plug, the socket should be replaced by a suitable one.

- Never spin items of laundry which have been cleaned, washed, impregnated or sprayed with wax, paint, petrol or inflammable liquids. The vapours can constitute a fire hazard or cause an explosion. Always wash materials containing these substances by hand first and let them dry outside in the fresh air.
- Do not use the appliance as a footboard or load heavy items onto it.
- Do not reach into the drum while it is spinning.
- Do not store the spin dryer directly next to a hot stove or heater.
- In general, we recommend avoiding the use of multiple plug sockets, extension cables and adapters.
- Pull out the plug
 - if the appliance malfunctions during operation;
 - before cleaning and maintenance;
 - after use.
- Operate the spin dryer only in an upright position on an even floor and maintain a distance of about 50 cm from the wall or other objects (Fig. B, Page 5).
- During operation, do not lift, carry, hold, move or tip over the appliance.
- Never handle the operating lever and lid with force.
- Lift or carry the appliance by the carrying handles only.
- Before disposal of the spin dryer, cut off the mains cable. Ensure that the appliance is disposed of carefully and orderly.

ELECTRICAL INFORMATION

WARNING: THIS APPLIANCE MUST BE EARTHED

The mains lead of this appliance is fitted with a BS 1363A 13 amp fused plug. To change a fuse in this type of plug use an A.S.T.A. approved fuse to BS 1362 type.

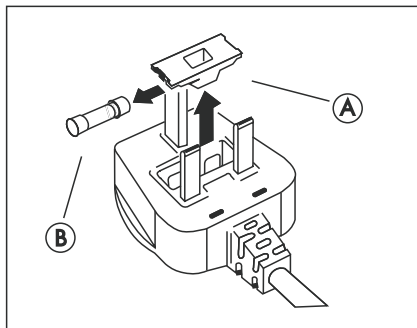

1. Remove the fuse cover (A) and fuse (B)
2. Fit replacement 13 A fuse into fuse cover
3. Refit both into plug

IMPORTANT:

The fuse cover must be refitted when changing a fuse and if the fuse cover is lost the plug must not be used until a correct replacement is fitted.

Correct replacements are identified by the colour insert or the colour embossed in words on the base of the plug.

- Replacement fuse covers are available from your local Electricity Board Shop.

HOW TO CONNECT AN ALTERNATIVE PLUG

If the fitted plug is not suitable for your socket outlet, then it should be cut off and disposed of in order to avoid a possible shock hazard should it be inserted into a 13 A socket elsewhere. A suitable alternative plug of a least 13 Amp rating e.g. 15 Amp round pin to BS546 should then be fitted to the cable.

The wires in this mains lead are coloured in accordance with the following code: -

BLUE - "NEUTRAL" ("N")

BROWN - "LIVE" ("L")

GREEN AND YELLOW - "EARTH" ("E")

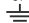
1. The GREEN AND YELLOW wire must be connected to the terminal in the plug which is marked with the letter "E" or by the Earth symbol  or coloured green or green and yellow.
2. The BLUE wire must be connected to the terminal which is marked with the letter "N" or coloured black.
3. The BROWN wire must be connected to the terminal which is marked with the letter "L" or coloured red.

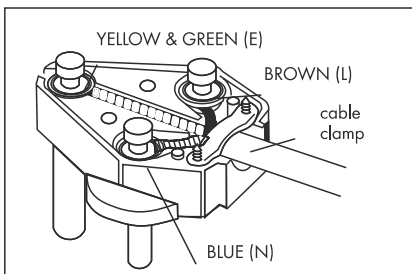

Operating Instructions

Congratulations on your new purchase

We recommend that you read these instructions carefully in order to quickly become familiar with your new appliance.

A good appliance, which is used properly, will serve you for many years.

Unpacking the appliance

Dispose of packing materials in accordance with local regulations.

Check the spin dryer for any transport damages, which must be reported to the forwarding agent or goods office responsible within 24 hours. In case of damage, kindly send all relevant paperwork to the Customer Service for further treatment.

Preparation for Use

1. Put the knob switch in the "OFF" (0) position. (A)

2. Open the lid.
3. Remove the transport safeguard from inside the spin drum.
4. We recommend that the spin drum be washed out with a standard detergent before using for the first time.
5. Place the spin dryer on a level floor at a distance of about 50 cm away from the wall or other objects. Never balance out irregularities in the floor surface by laying wood, paper or similar materials under the appliance. (B)

Loading the machine

1. Place a sufficiently large container for excess water under the outlet spout.
2. Plug the appliance in to a mains socket (please observe the Points of Safety).

3. Place each article of laundry **singly** in the spin drum. **Distribute** the washing **evenly** in the drum and **press down firmly**, so as to avoid leaving empty spaces (and thus avoiding excessive vibration of the machine during operation). (C)

4. The max. dry weight capacity and the electrical ratings are to be found on the rating plate or to be obtained in consulting your dealer.

5. Do not place rolled-up items of clothing (e.g. jeans) in the spin dryer. (F)

6. Press the loaded washing down, so that there is a gap of at least 3 cm between the washing and the top edge of the drum. Lastly, cover the washing with a cloth, the ends of which should be tucked well down inside the drum, so as to avoid items of washing being catapulted out during operation. (D)

7. Close the lid.

Switch on the appliance (A)

Turn the knob switch to the right as far as it will go to the "5 min" position.

The spin dryer is now in operation and water flows out of the outlet spout.

Spin Drying Times

For normal washing: 3-5 minutes.

The residual moisture amounts to:

- approx: 65% in machines with a spin speed of 1400 rpm;
- approx: 40% in machines with a spin speed of 2800 rpm;

For washing which requires no ironing: 15-30 seconds max.

Switch of the appliance

When water ceases to flow out of the outlet spout, or when the spin process is to be terminated, turn the operating lever back to the left to the "OFF" (O) position.

When the drum has come to a standstill, open the lid. A special safety device prevents the lid being opened before the drum has stopped spinning.

Never force the lid open (E)

Remove the laundry from the drum.

Gently tilt the spin forward, so that any remaining water can flow out of the outlet spout.

Pull out the plug.

- Clean the exterior of the spin dryer with a damp cloth and wipe it dry.
- Use standard detergents only to clean the appliance.
- Do not use abrasive cleaning agents.
- Never use petrol or other solvent liquids.
- The spin dryer requires no other maintenance.

If unexpected difficulties arise

- Before contacting your dealer, check whether the fault is due to one of the following minor causes.

The motor does not function:

- Has the fuse blown?
- Is there damage to the mains cable, plug or socket? Pull out the plug before checking!
- Never open the motor yourself!

Water does not flow out:

- Pull out the plug! Check whether the outlet spout is blocked by a piece of washing.
- Press the spin drum from the inside against the outer casing with your hand and remove the piece of washing.

The spin dryer does not pick up spin speed:

- Please note that the spin dryer normally overcomes a certain amount of unbalance itself when picking up spin speed. The motor and spin drum are suspended flexibly for that reason.
- However, if the unbalance is too great (brought about by incorrect loading of the spin dryer), the machine cannot pick up spin speed.

The spin dryer "jumps":

1. Switch off the spin dryer immediately!
2. When the drum has come to a standstill, repack the washing evenly.
3. Reload the spin dryer in accordance with the instructions given on the previous page.

Maintenance and Care

- Always pull out the plug before cleaning the appliance!
- After use, wipe the spindrum dry with a cloth.
- If dirty washing has been spun, it is necessary to rinse the drum out with clear water in order to avoid soiling the next load of washing.

Technical parameter

Technical parameter	Model number	CSPD4WH CSPD4BK
Nmae		
Product dimension		370mm*420mm*650mm
Packaging dimension		420mm*420mm*700mm
Product weight		12kg
Power of spin drying		260W
Rated voltage		220V
Rated frequency		50Hz
Rated spin drying capacity		4.0kg
Spin drying speed		2800r/min
Open mode		Top opening type
Control mode		Mechanical (1-5 minute timer)
Drainage mode		Automatic drum external drainage
Outer drum material		Galvanized
Inner drum material		Stainless steel

Cookology

Address : 7 Meadow Business Park, Piperell Way, Haverhill, CB9 8QX

Tel : 08000 308 444

Email : help@cookology.com



The symbol on the product or on its packaging indicates that this product may not be treated as household waste. Instead it shall be handed over to the applicable collection point for the recycling of electrical and electronic equipment. By ensuring this product is disposed of correctly, you will help prevent potential negative consequences for the environment and human health, which could otherwise be caused by inappropriate waste handling of this product. For more detailed information about recycling of this product, please contact your local city office, your household waste disposal service or the shop where you purchased the product.